

Replacing the Battery Pet Immune Motion Detector

DSC PG9914/PG8914/PG4914

CAUTION! Risk of explosion if battery is replaced by an incorrect type. Dispose of used batteries according to the manufacturer's instructions.

WARNING! This product contains a coin battery. If it is swallowed, it can cause severe internal burns in just 2 hours and can lead to death. Keep new and used batteries away from children. If the battery compartment does not close securely, stop using the product and keep it away from children. If you think batteries might have been swallowed or placed inside any part of the body, seek immediate medical attention.

The DSC PG9914 PIR Pet-Immune motion detector requires a 3-volt lithium CR123A battery, which can be purchased at your local hardware, mass retailer, or battery store.

Step-by-Step Instructions:

1. Locate the sensor with a low battery on either your system panel or in the Mobile App.
2. Bypass the sensor on your panel following these instructions: **IQ Panel 2 - Bypass & Force Bypass Sensors.**
3. To open the cover, remove the locking screw from the bottom, then press the tab at the bottom of the sensor to remove the cover.

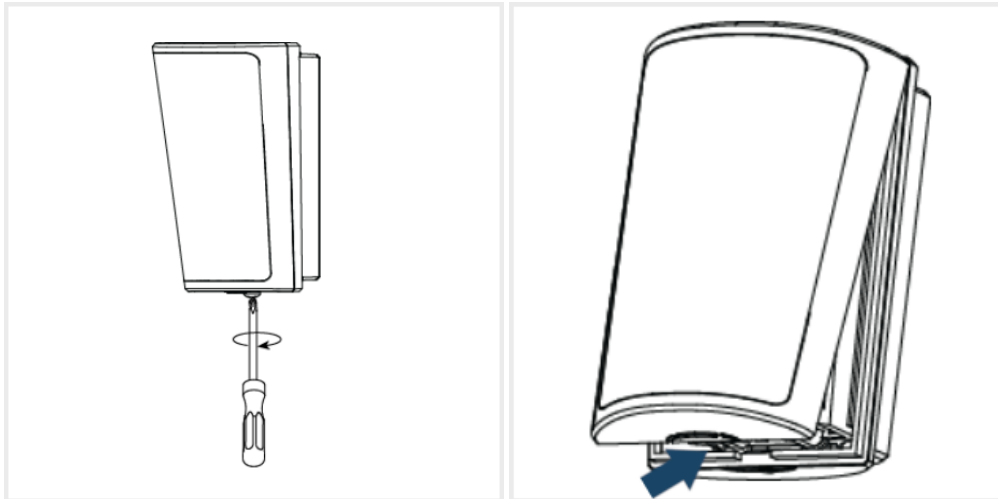

4. Remove and replace the 3-volt lithium CR123A battery.



5. Make sure the area where the batteries are stored is clean and there is no corrosion.
6. Put the cover back on starting with the opposite end from which it was opened. You should hear a snapping sound if it closes correctly.
7. Arm and disarm the system to clear the bypassed sensor.
8. Check if the low battery status has cleared or follow the link below for further instructions on clearing the error from the panel memory: **IQ Panel 2 System Sensor Status**.